

SC-Cut OCXO

Series **COC36**

Applications

- * Cellular Base Station
- * GSM & CDMA System
- * Test Equipment
- * Frequency Synthesizer
- * Digital Switching

Features

- * High Reliability
- * Low Aging
- * Excellent Phase Noise
- * Mass Production With Good Uniformity
- * ROHS Compliant

- * Custom Build Capability
- * SC-Cut



Part Numbering Example: **COC36Z-A213.000**

COC36 **Z** - **A2** **13.000**

SERIES	ADDED FEATURES	OPERATING TEMP.	FREQUENCY
COC36	Blank = Bulk Package T = Tube Z = Tape and Reel	A2 = -40° to + 85°C	13 MHz

<i>Specifications:</i>	<i>Min</i>	<i>Typ</i>	<i>Max</i>	<i>Unit</i>
Frequency Range:		13		MHz
Frequency Tolerance:		0.1		ppm
Frequency Stability Vs. Temperature:		10		ppb
Storage Temperature Range:	-45		+85	°C
Supply Voltage:	11.4	12	12.6	V
Operating Temperature:	-40		+ 70	°C
Load Stability:		1		ppb
Power Supply Stability:		1		ppb
Maximum aging rate after power on 30 days			0.1 0.4 1.0	ppm/1yr ppm/10yr ppb/day
Short-Time Frequency Stability:			0.02	ppb/second
Initial Current:		350		mA
Steady State Current		100		mA
Phase Noise:				
1 Hz		-80		dBc
10 Hz		-120		dBc
100 Hz		-140		dBc
1 kHz		-150		dBc
10 kHz		-155		dBc
Linearity:		<15		%
Output Waveform:	Sine			
Output Level:	+9 ±2dBm			
Output Load:	50 Ω			
Packaging:	36.2mm X 27.3mm X 13mm			



SC-Cut OCXO

Series

COC36

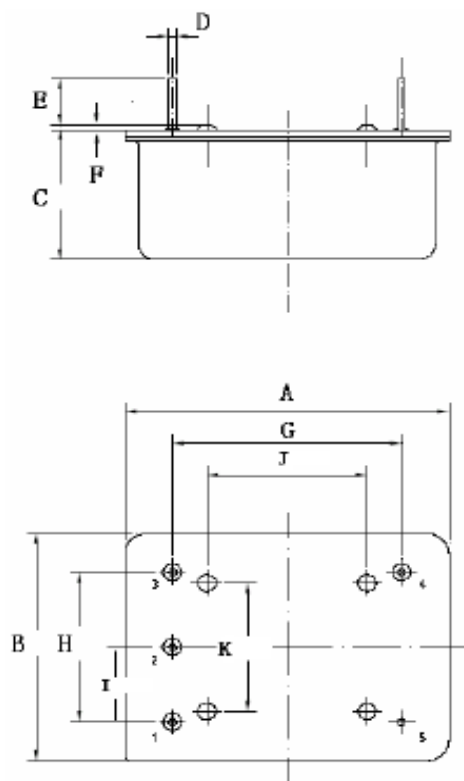

Pin No.	Pin Function
1	Control Voltage
2	N/C
3	Supply Voltage
4	Output
5	GND

Symbol	Dimension (mm)	
	Min	Max
A		36.2
B		27.3
C		13
D	0.7	0.9
E	3.2	3.6
F	0.6	0.8
G	25.2	25.6
H	17.6	18.0
I	8.89	8.91
J	17.78 nominal	
K	15.24 nominal	



Wayne, NJ 07470

CARDINAL COMPONENTS



WEB:
FAX:

<http://www.cardinalxtal.com>
(973)785-0053