

Surface Mount VCXO

• Plastic package

Series **CC165**



Part Numbering Example: **CC165 L Z - A6 BP 45 - 22.5792 A**

CC165	L	Z	A6	BP	45	22.5792	A
SERIES	VOLTAGE	PACKAGING OPTIONS	OPERATING TEMP.	STABILITY	SYMMETRY	FREQUENCY	PULL RANGE
CC165	Blank = 5V L = 3.3V	Blank = Bulk Z = Tape and Reel	A6 = -0°C ~+70°C	B7 = ±30 ppm BD = ±20 ppm BP = ±50 ppm	Blank = 40/60% 45 = 45/55%		H = ±80 ppm B = ±100 ppm

Specifications:

Frequency Range:	8.000 MHz to 30.000 MHz
Available Stability Options:	±50 ppm
Output Series:	TTL/HCMOS
Input Voltage:	+5.0 VDC ±5% +3.3 VDC ±5%
Frequency Tuning Range:	±80 ppm Min. (3.3Vdc) ±100 ppm Min.(5.0Vdc)
External Control Voltage:	+2.5 VDC ± 2.0 VDC @ 5 V INPUT +1.5 VDC ± 1.0 VDC @ 3.3 V INPUT
Output Voltage:	HCMOS $V_{OL}=10\%V_{DD}$ V Max. HCMOS $V_{OH}=90\%V_{DD}$ V Min.
Operating Temperature Range Options:	-0°C to +60°C
Output Load:	15 pf @ +5 VDC 15 pf @ +3.3 VDC
Maximum Input Current:	30 mA
Duty Cycle:	40/60% 45/55%
Storage Temperature:	-50°C to +125°C
Packaging:	Tape and Reel (1K per Reel)

CC165

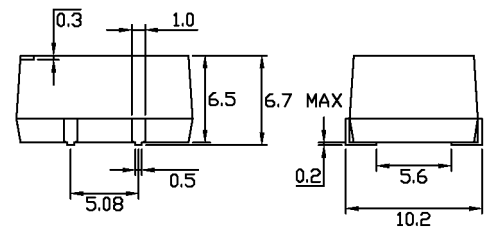
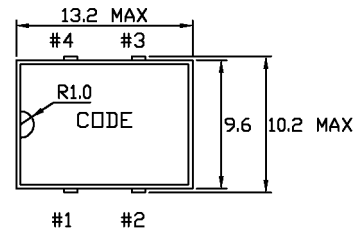

RECOMMENDED SOLDER PAD LAYOUT

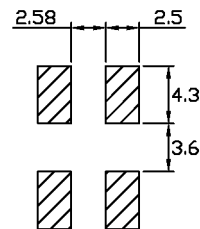

- PINOUT
- 1 NC/TRI-STATE
  - 2 GND
  - 3 OUTPUT
  - 4 Vcc

